

HINGES

STERLING® HINGES

SECTION 6.2 SHEET 1 of 10

ISSUE: March, 2006

ASSEMBLY SHEET - SPT10 Top Hung Hinge

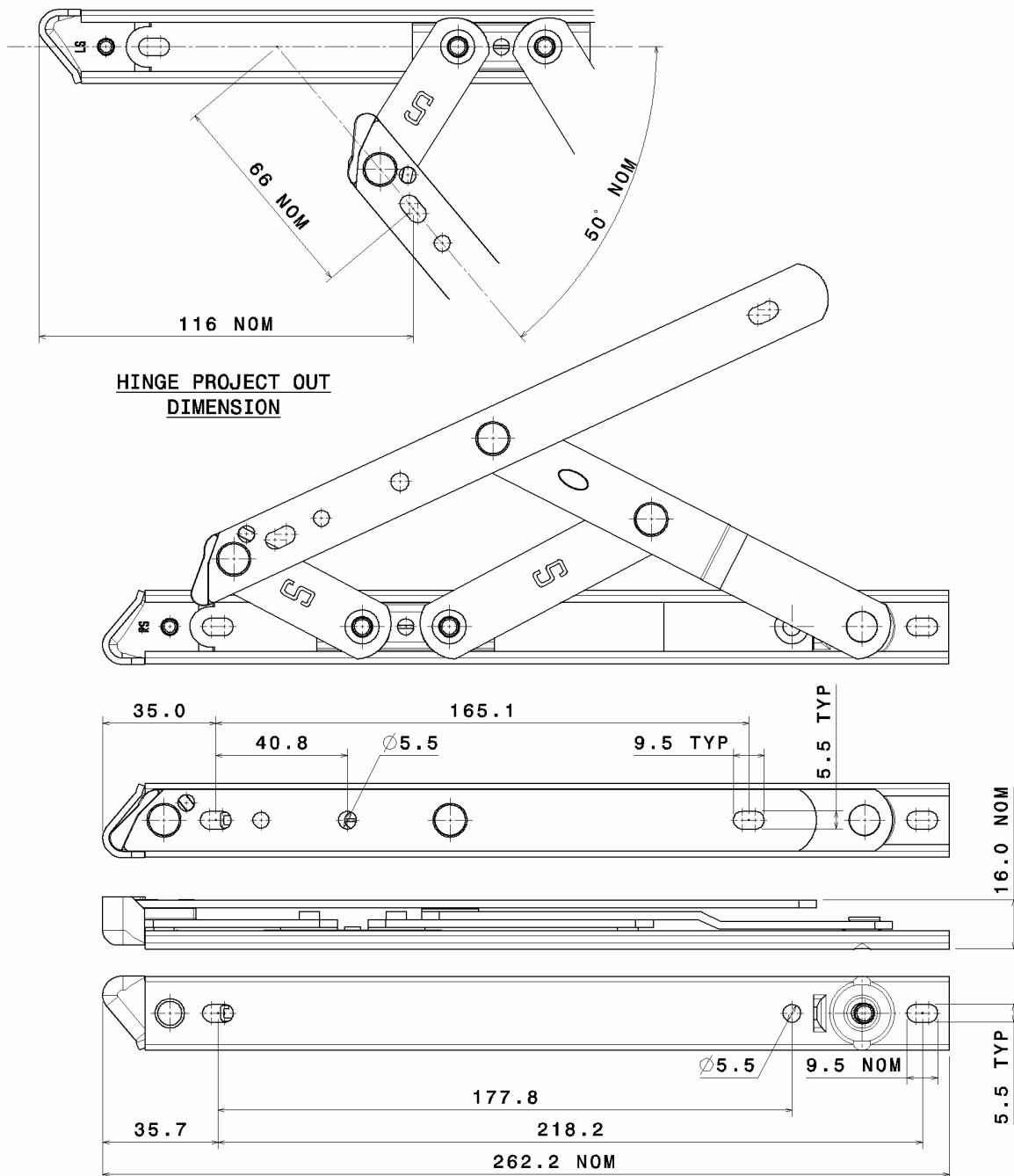

Hinge Code	Max. Vent Weight (Kg)	Min. Vent Height (mm)	Max. Vent Height (mm)	Max. Vent Width (mm)	Hardware Cavity (mm)
SPT10	37	267	635	See profile manufacturers recommendations	16 - 18

Not to Scale, All dimensions in mm

It is the responsibility of the user to ensure that this document is at the latest issue.

Due to our policy of continual product improvement we reserve the right to alter specifications without notice.

It is the responsibility of the window manufacturer to ensure that the finished window meets the required performance and safety specification.

© SECURISTYLE LTD 2006



Securistyle Ltd.
Kingsmead Industrial Estate
Princess Elizabeth Way, Cheltenham,
Gloucestershire, GL51 7RE
Tel: +44 (0) 1242 221200
Fax: +44 (0) 1242 520828
Web: www.securistyle.co.uk

HINGES

STERLING® HINGES

SECTION 6.2 SHEET 2 of 10

ISSUE: March, 2006

ASSEMBLY SHEET - SPT12 Top Hung Hinge

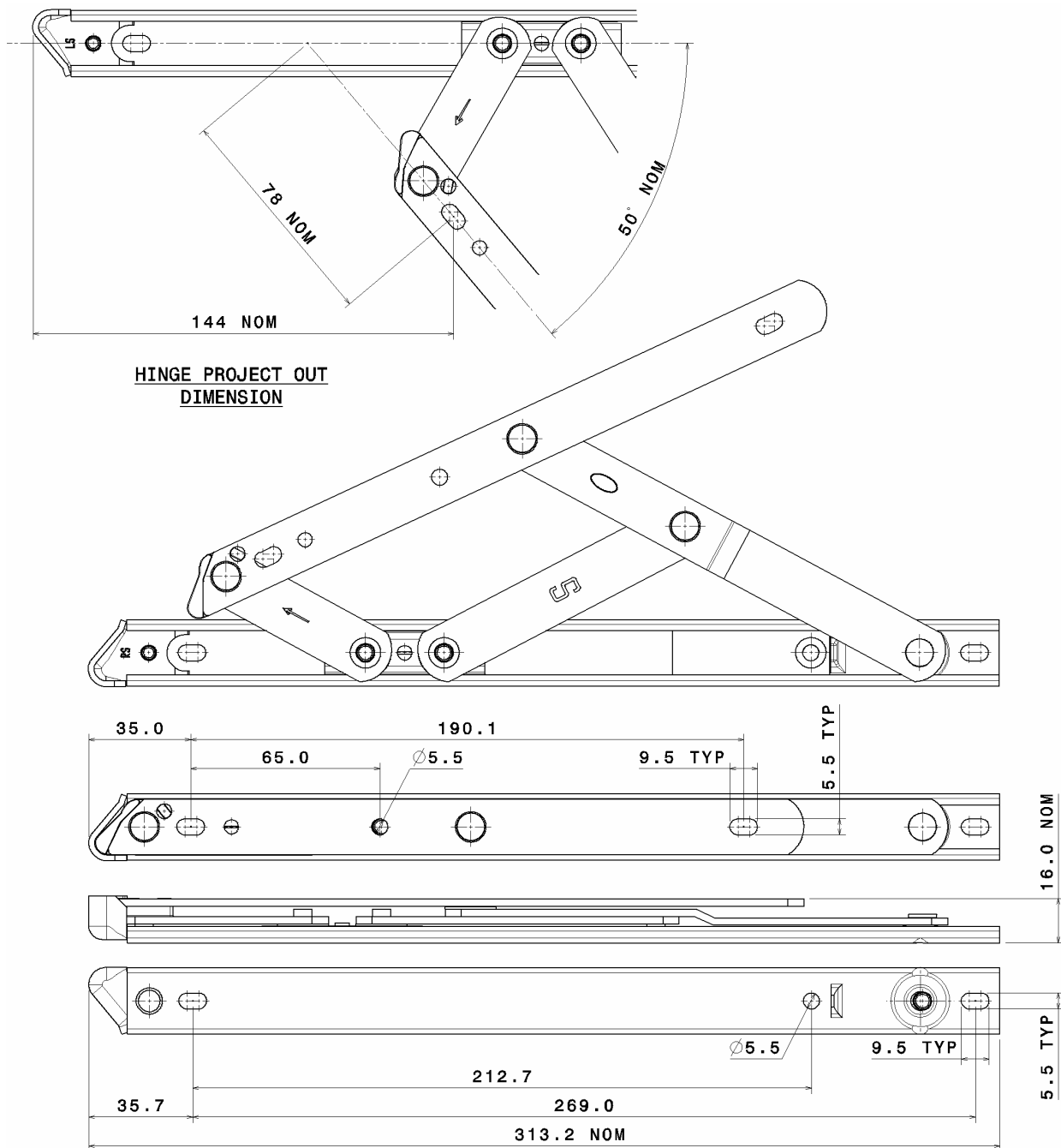

Hinge Code	Max. Vent Weight (Kg)	Min. Vent Height (mm)	Max. Vent Height (mm)	Max. Vent Width (mm)	Hardware Cavity (mm)
SPT12	45	635	787	See profile manufacturers recommendations	16 - 18

Not to Scale, All dimensions in mm

It is the responsibility of the user to ensure that this document is at the latest issue.

Due to our policy of continual product improvement we reserve the right to alter specifications without notice.

It is the responsibility of the window manufacturer to ensure that the finished window meets the required performance and safety specification.

© SECURISTYLE LTD 2006



Securistyle Ltd.
Kingsmead Industrial Estate
Princess Elizabeth Way, Cheltenham,
Gloucestershire, GL51 7RE
Tel: +44 (0) 1242 221200
Fax: +44 (0) 1242 520828
Web: www.securistyle.co.uk

HINGES

STERLING® HINGES

SECTION 6.2 SHEET 3 of 10

ISSUE: March, 2006

ASSEMBLY SHEET - SPT16 Top Hung Hinge

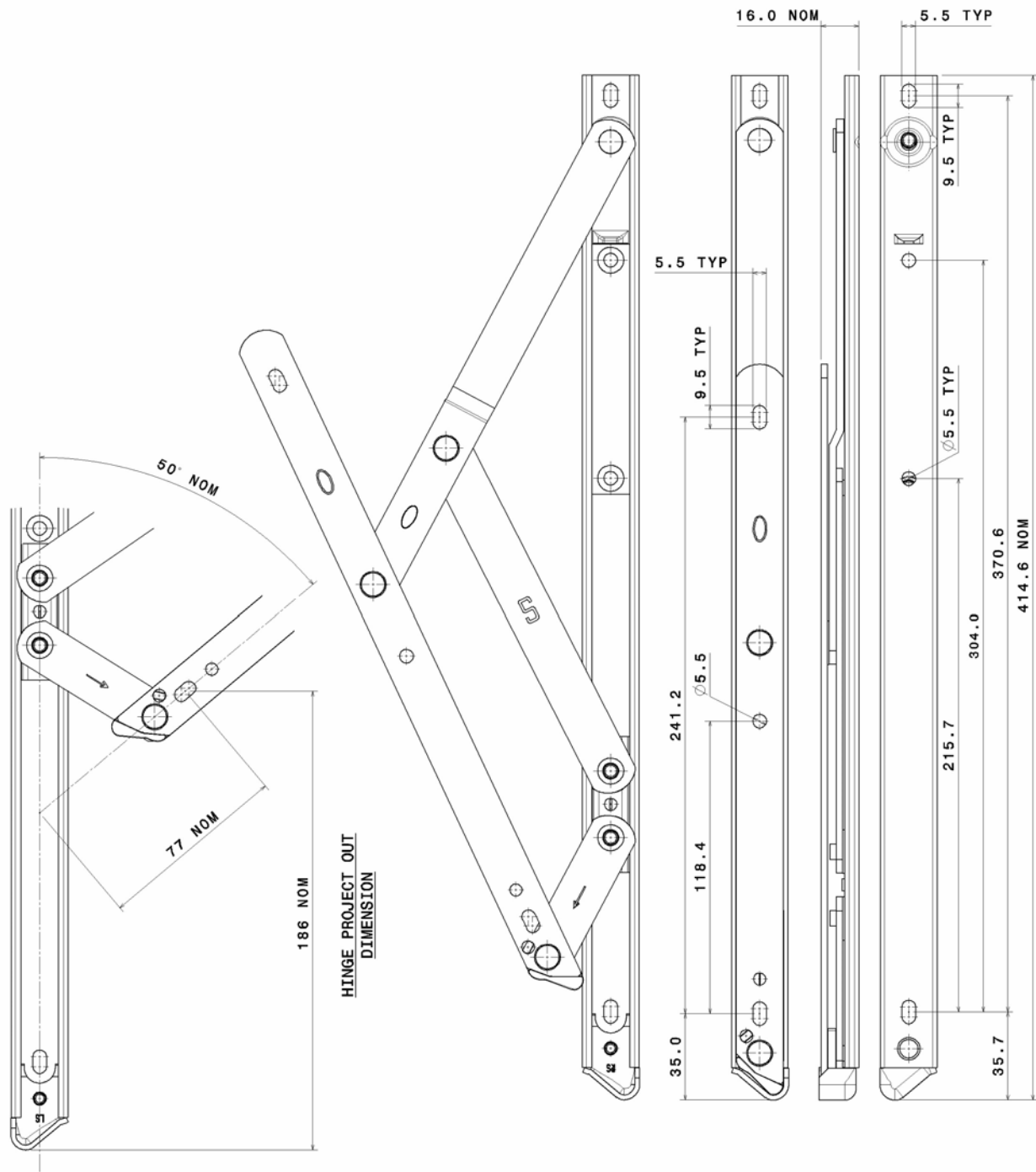

Hinge Code	Max. Vent Weight (Kg)	Min. Vent Height (mm)	Max. Vent Height (mm)	Max. Vent Width (mm)	Hardware Cavity (mm)
SPT16	55	787	1090	See profile manufacturers recommendations	16 - 18

Not to Scale, All dimensions in mm

It is the responsibility of the user to ensure that this document is at the latest issue.

Due to our policy of continual product improvement we reserve the right to alter specifications without notice.

It is the responsibility of the window manufacturer to ensure that the finished window meets the required performance and safety specification.

© SECURISTYLE LTD 2006



Securistyle Ltd.
Kingsmead Industrial Estate
Princess Elizabeth Way, Cheltenham,
Gloucestershire, GL51 7RE
Tel: +44 (0) 1242 221200
Fax: +44 (0) 1242 520828
Web: www.securistyle.co.uk

HINGES

STERLING® HINGES

SECTION 6.2 SHEET 4 of 10

ISSUE: March, 2006

ASSEMBLY SHEET - SPT16W Top Hung Hinge

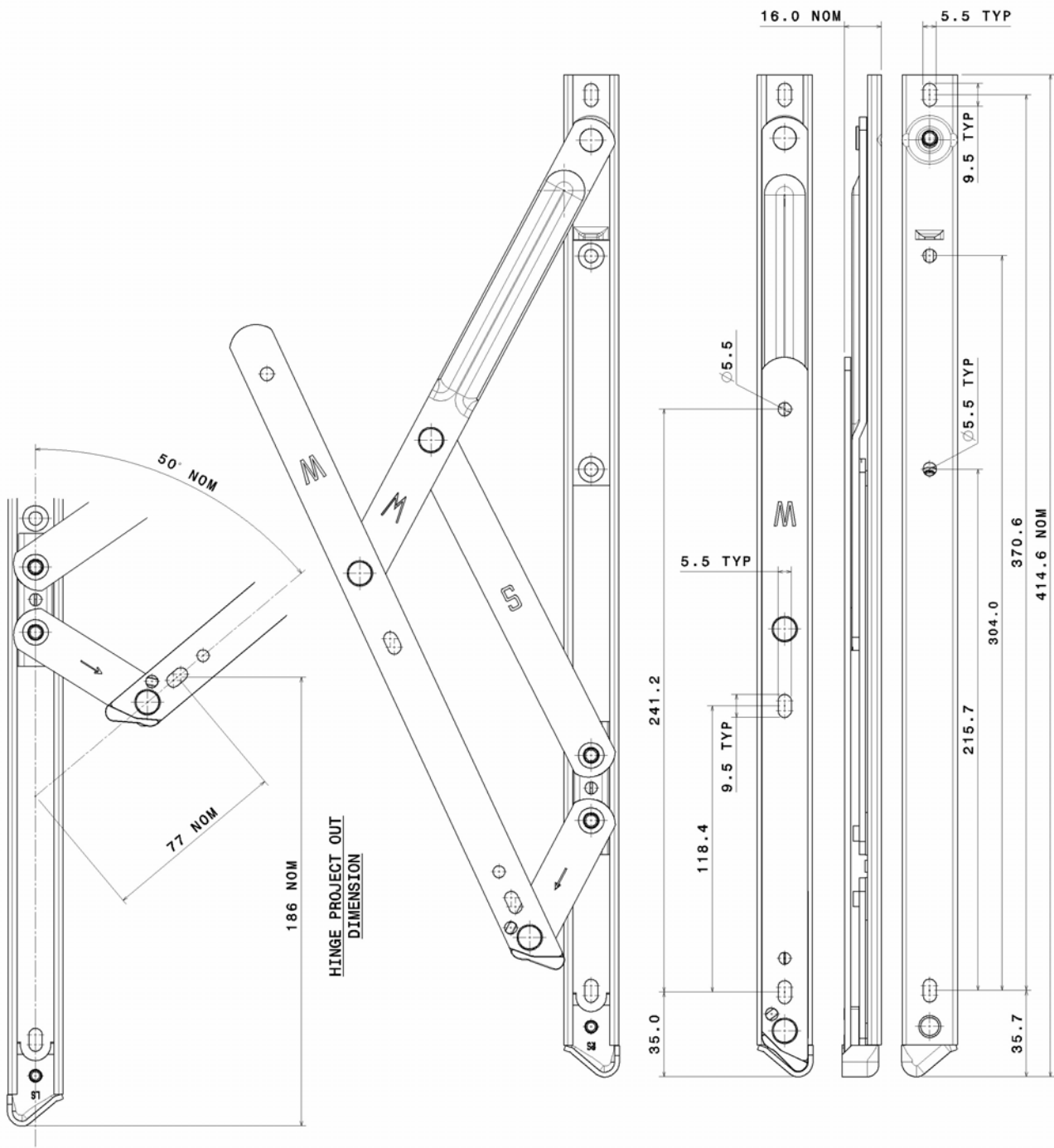

Hinge Code	Max. Vent Weight (Kg)	Min. Vent Height (mm)	Max. Vent Height (mm)	Max. Vent Width (mm)	Hardware Cavity (mm)
SPT16W	55	787	1090	See profile manufacturers recommendations	16 - 18

Not to Scale, All dimensions in mm

It is the responsibility of the user to ensure that this document is at the latest issue.

Due to our policy of continual product improvement we reserve the right to alter specifications without notice.

It is the responsibility of the window manufacturer to ensure that the finished window meets the required performance and safety specification.

© SECURISTYLE LTD 2006



Securistyle Ltd.
Kingsmead Industrial Estate
Princess Elizabeth Way, Cheltenham,
Gloucestershire, GL51 7RE
Tel: +44 (0) 1242 221200
Fax: +44 (0) 1242 520828
Web: www.securistyle.co.uk

HINGES

STERLING® HINGES

SECTION 6.2 SHEET 5 of 10

ISSUE: March, 2006

ASSEMBLY SHEET - SPTH16 Top Hung Hinge

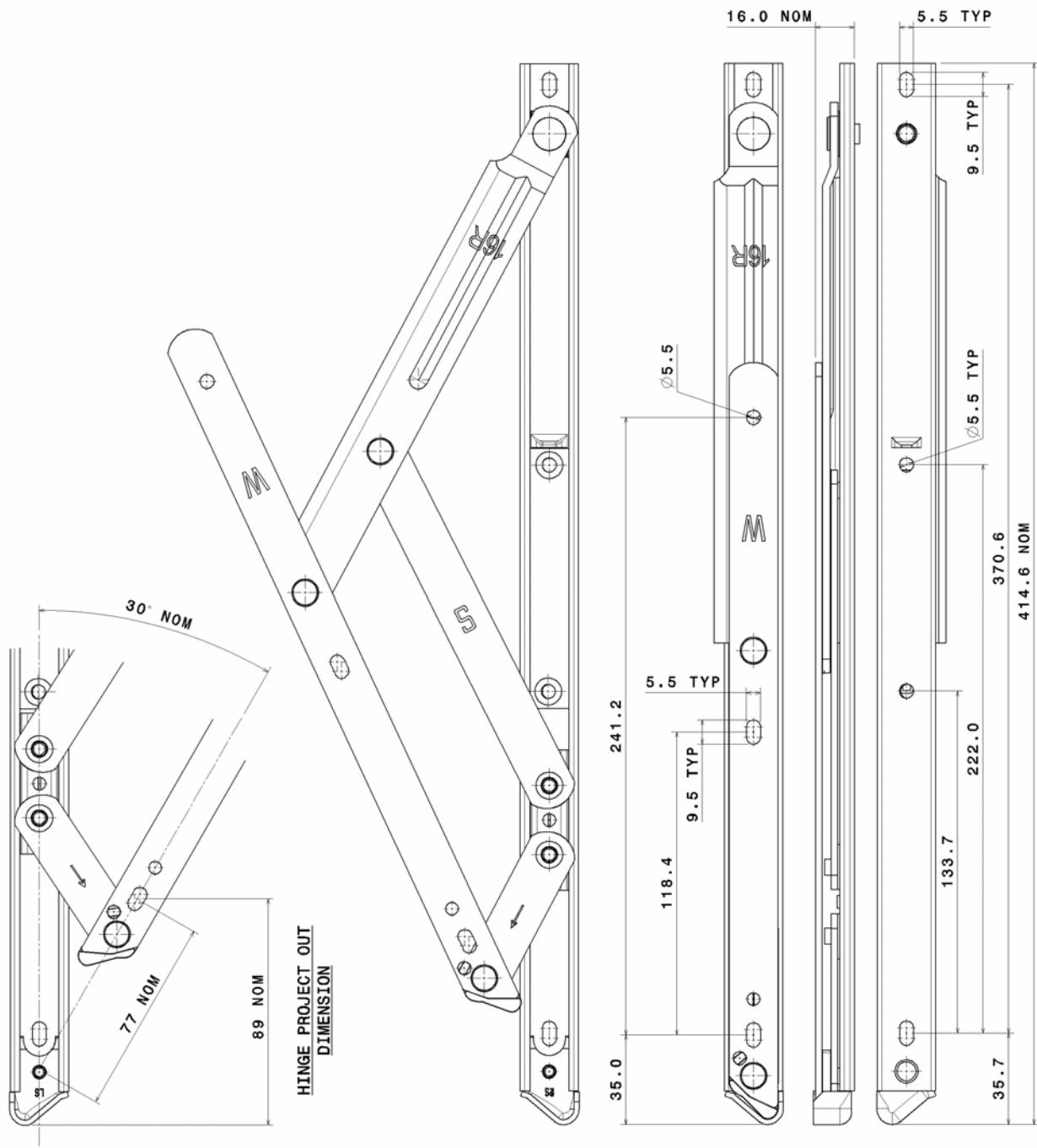

Hinge Code	Max. Vent Weight (Kg)	Min. Vent Height (mm)	Max. Vent Height (mm)	Max. Vent Width (mm)	Hardware Cavity (mm)
SPTH16	75	1090	1500	See profile manufacturers recommendations	16 - 18

Not to Scale, All dimensions in mm

It is the responsibility of the user to ensure that this document is at the latest issue.

Due to our policy of continual product improvement we reserve the right to alter specifications without notice.

It is the responsibility of the window manufacturer to ensure that the finished window meets the required performance and safety specification.

© SECURISTYLE LTD 2006



Securistyle Ltd.
Kingsmead Industrial Estate
Princess Elizabeth Way, Cheltenham,
Gloucestershire, GL51 7RE
Tel: +44 (0) 1242 221200
Fax: +44 (0) 1242 520828
Web: www.securistyle.co.uk

ISSUE: March, 2006

Technical drawing of a window hinge assembly, showing side and front views with dimensions.

Side View Dimensions:

- Overall height: 217 NOM
- Angle: 45° NOM
- Distance from top edge to hinge center: 78 NOM
- Distance from hinge center to bottom edge: 217 NOM
- Distance from hinge center to top edge: 78 NOM
- Distance from hinge center to bottom edge: 217 NOM

Front View Dimensions:

- Overall width: 16.0 NOM
- Distance from top edge to hinge center: 317.4
- Distance from hinge center to bottom edge: 203.2
- Distance from hinge center to top edge: 317.4
- Distance from hinge center to bottom edge: 203.2
- Distance from hinge center to top edge: 317.4
- Distance from hinge center to bottom edge: 203.2
- Distance from hinge center to top edge: 317.4
- Distance from hinge center to bottom edge: 203.2

Other Dimensions:

- Distance from hinge center to top edge: 317.4
- Distance from hinge center to bottom edge: 203.2
- Distance from hinge center to top edge: 317.4
- Distance from hinge center to bottom edge: 203.2
- Distance from hinge center to top edge: 317.4
- Distance from hinge center to bottom edge: 203.2
- Distance from hinge center to top edge: 317.4
- Distance from hinge center to bottom edge: 203.2

Securistyle Ltd.
Kingsmead Industrial Estate
Princess Elizabeth Way, Cheltenham,
Gloucestershire, GL51 7RE
Tel: +44 (0) 1242 221200
Fax: +44 (0) 1242 520828
Web: www.securistyle.co.uk

HINGES

STERLING® HINGES

SECTION 6.2 SHEET 7 of 10

ISSUE: March, 2006

ASSEMBLY SHEET - SPT22W Top Hung Hinge

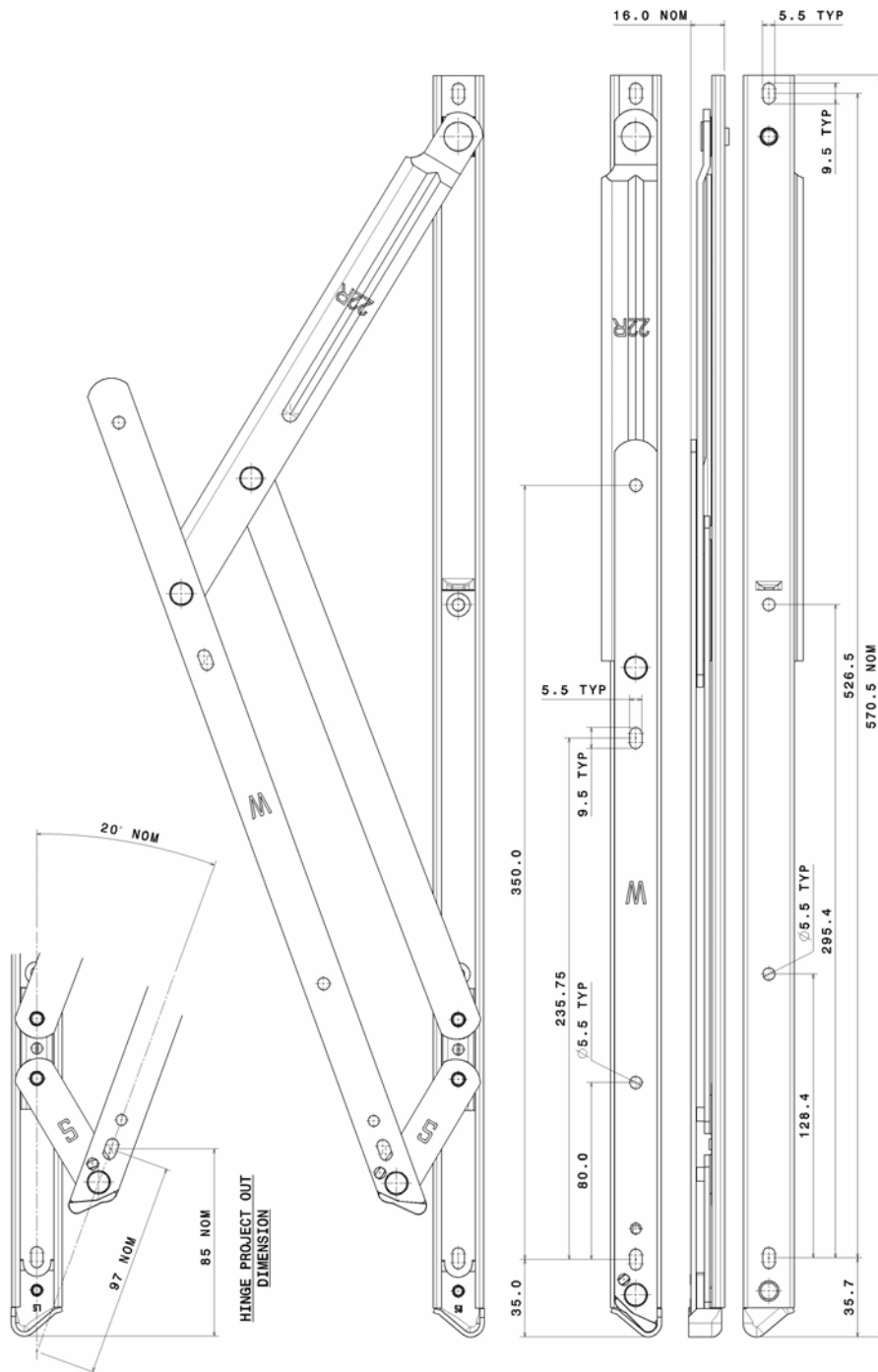

Hinge Code	Max. Vent Weight (Kg)	Min. Vent Height (mm)	Max. Vent Height (mm)	Max. Vent Width (mm)	Hardware Cavity (mm)
SPT22W	100	TBA	1750	See profile manufacturers recommendations	16 - 18

Not to Scale, All dimensions in mm

It is the responsibility of the user to ensure that this document is at the latest issue.

Due to our policy of continual product improvement we reserve the right to alter specifications without notice.

It is the responsibility of the window manufacturer to ensure that the finished window meets the required performance and safety specification.

© SECURISTYLE LTD 2006



Securistyle Ltd.
Kingsmead Industrial Estate
Princess Elizabeth Way, Cheltenham,
Gloucestershire, GL51 7RE
Tel: +44 (0) 1242 221200
Fax: +44 (0) 1242 520828
Web: www.securistyle.co.uk

HINGES

STERLING® HINGES

SECTION 6.2 SHEET 8 of 10

ISSUE: March, 2006

ASSEMBLY SHEET - SPT26 Top Hung Hinge

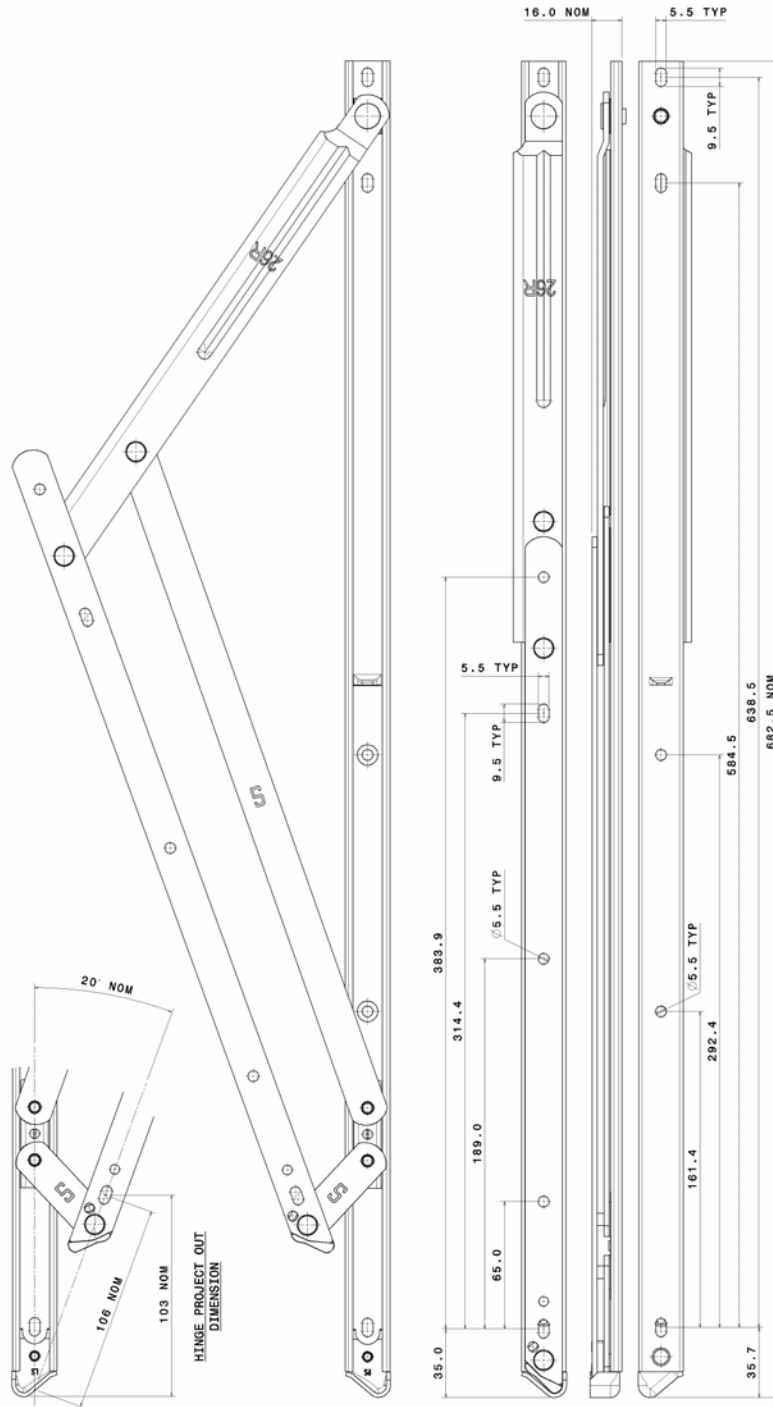

Hinge Code	Max. Vent Weight (Kg)	Min. Vent Height (mm)	Max. Vent Height (mm)	Max. Vent Width (mm)	Hardware Cavity (mm)
SPT26	180	TBA	2500	See profile manufacturers recommendations	16 - 18

Not to Scale, All dimensions in mm

It is the responsibility of the user to ensure that this document is at the latest issue.

Due to our policy of continual product improvement we reserve the right to alter specifications without notice.

It is the responsibility of the window manufacturer to ensure that the finished window meets the required performance and safety specification.

© SECURISTYLE LTD 2006



Securistyle Ltd.
Kingsmead Industrial Estate
Princess Elizabeth Way, Cheltenham,
Gloucestershire, GL51 7RE
Tel: +44 (0) 1242 221200
Fax: +44 (0) 1242 520828
Web: www.securistyle.co.uk

HINGES

STERLING® HINGES

SECTION 6.2 SHEET 9 of 10

ISSUE: March, 2006

ASSEMBLY SHEET - SPS10 Side Hung Hinge

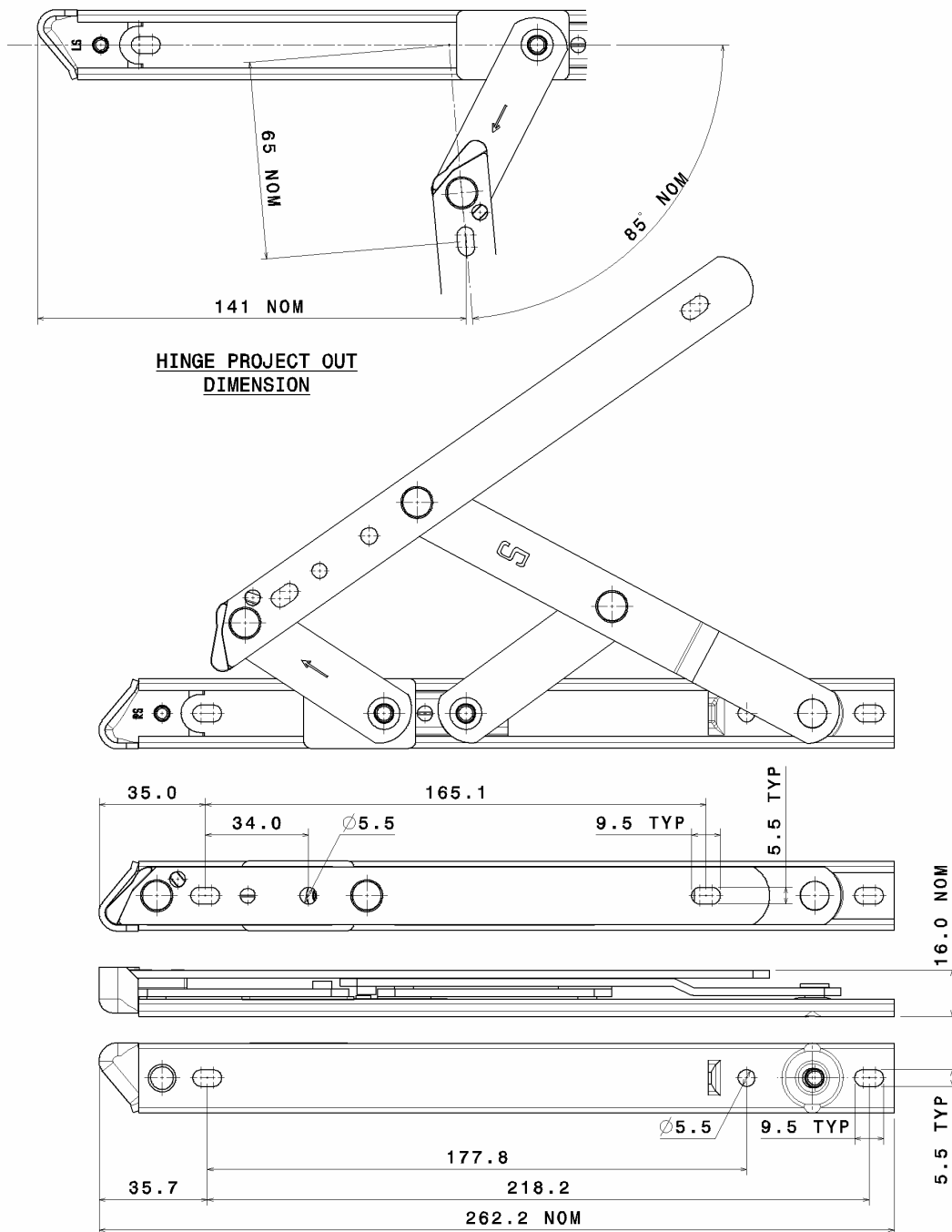

Hinge Code	Max. Vent Weight (Kg)	Min. Vent Width (mm)	Max. Vent Width (mm)	Max. Vent Height (mm)	Hardware Cavity (mm)
SPS10	38	300	660	See profile manufacturers recommendations	16 - 18

Not to Scale, All dimensions in mm

It is the responsibility of the user to ensure that this document is at the latest issue.

Due to our policy of continual product improvement we reserve the right to alter specifications without notice.

It is the responsibility of the window manufacturer to ensure that the finished window meets the required performance and safety specification.

© SECURISTYLE LTD 2006



Securistyle Ltd.
Kingsmead Industrial Estate
Princess Elizabeth Way, Cheltenham,
Gloucestershire, GL51 7RE
Tel: +44 (0) 1242 221200
Fax: +44 (0) 1242 520828
Web: www.securistyle.co.uk

HINGES

STERLING® HINGES

SECTION 6.2 SHEET 10 of 10

ISSUE: March, 2006

ASSEMBLY SHEET - SPS16

Side Hung Hinge

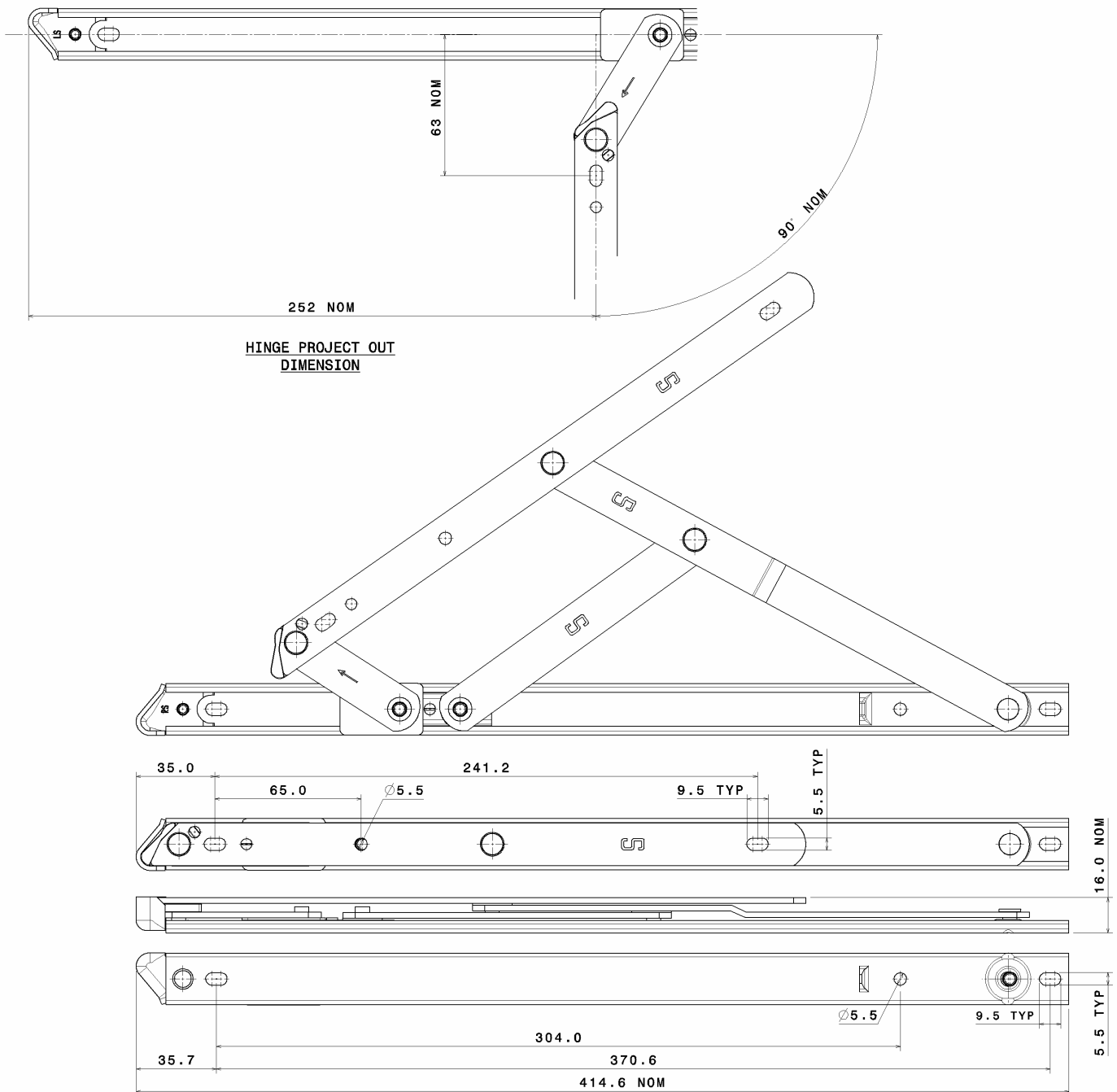

Hinge Code	Max. Vent Weight (Kg)	Min. Vent Width (mm)	Max. Vent Width (mm)	Max. Vent Height (mm)	Hardware Cavity (mm)
SPS16	47	450	838	See profile manufacturers recommendations	16 - 18

Not to Scale, All dimensions in mm

It is the responsibility of the user to ensure that this document is at the latest issue.

Due to our policy of continual product improvement we reserve the right to alter specifications without notice.

It is the responsibility of the window manufacturer to ensure that the finished window meets the required performance and safety specification.

© SECURISTYLE LTD 2006



Securistyle Ltd.
Kingsmead Industrial Estate
Princess Elizabeth Way, Cheltenham,
Gloucestershire, GL51 7RE
Tel: +44 (0) 1242 221200
Fax: +44 (0) 1242 520828
Web: www.securistyle.co.uk