

Tilt-turn and Side hung fittings



Tilt-turn, Side hung and Slave leaf fittings JET AK 8
for aluminium windows and doors



Advantages:

- RAL Test Certificate for the complete hardware system
- Elegant, uniform styling of stay arm bearing and corner bearing, flush with the sash overlap
- All bearing parts completely clampable, thus no drilling necessary
- Stepless lateral and height adjustment
- Pre-mounted structural components
- Optionally with geared handle or mill-in gear with integrated wrong operation safety device
- Reversible for DIN left hand and DIN right hand

Range of applications:

Sash width from 355 to 1700 mm

Sash height from 500 to 2400 mm

Sash weight to 80 kg, optional to 130 kg
with use of additional parts on hinge side

The programme of fittings JET AK 8 is adapted to windows with a rebate clearance of 21 mm, Euro-groove 15 x 20 mm in the sash and groove 12 x 15, 14 x 18 or 10 x 14 mm in the frame.

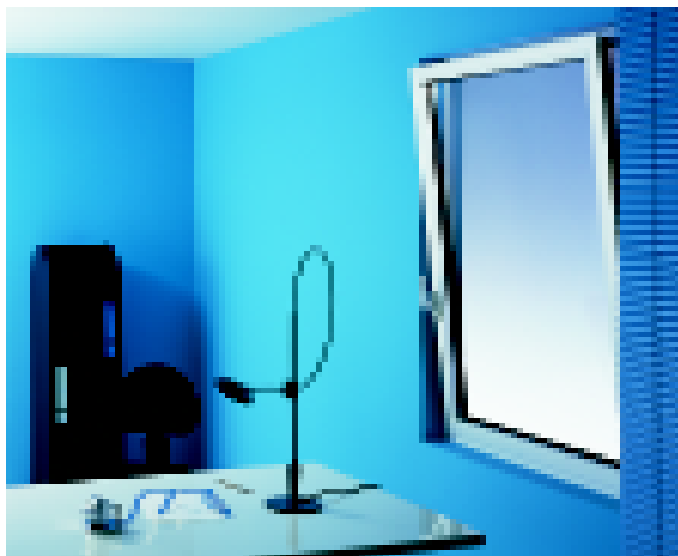



Handle DIRIGENT



Geared handle SPACIO
(Alternative: ADAGIO-A)



Handles for mill-in gears

Handle DIRIGENT-F
Handle DIRIGENT-F with push-
button cylinder, to RAL 607/9

Handle ADAGIO-F
Handle ADAGIO-F with push-
button cylinder, to RAL 607/9

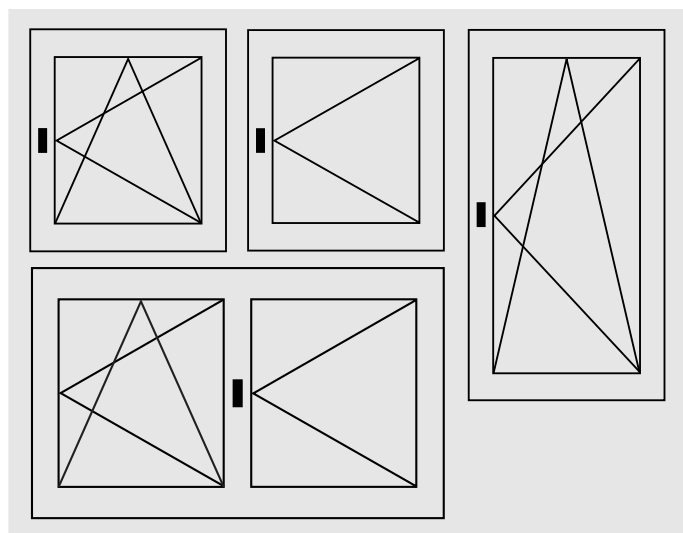

Tilt-turn sash JET AK 8 with
mill-in gear



Tilt-turn sash JET AK 8 with
wrong operation safety device



Mill-in gears, 180°

with wrong operation safety
device are used for tilt-turn
sashes; without wrong operation
safety device for side hung and
tilt sashes (Handles DIRIGENT
or ADAGIO-F as shown).

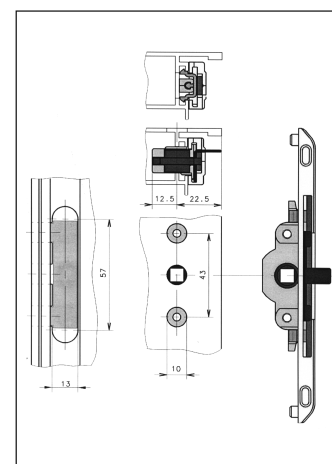

Clip hooks hold the mill-in
gear securely in the hard-
ware groove, even before
the handle is installed.
The backset is 14 mm.



Stay arm for tilt-turn sashes

This stay arm allows both left hand and right hand installation. Adjustment possibilities: lifting and lowering of sash ± 3 mm, sash pressure ± 1 mm, with 4 mm Allen key. Fastening on sash with grub screw, thus no pre-drilling necessary.

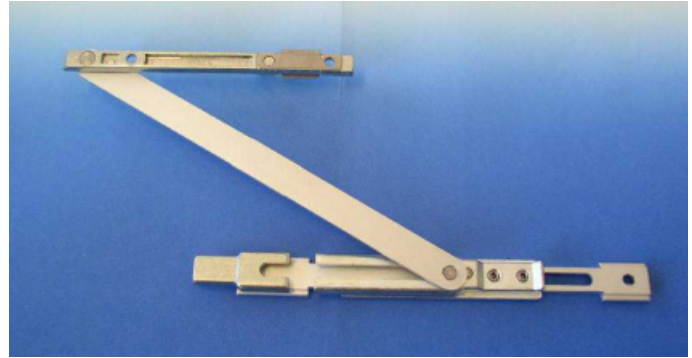

Additional stay arm for tilt-turn sashes

The additional stay arm is only used for sash widths exceeding 1400 mm and in connection with the stay arm size 50. It extends the range of applications for sash widths to 1700 mm.

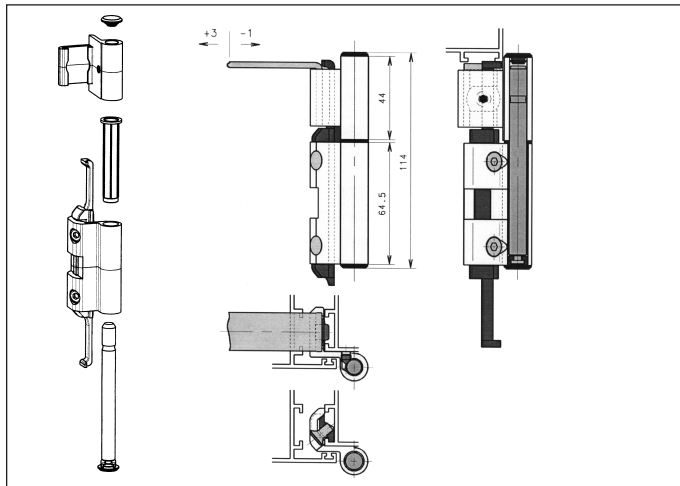

Stay arm bearing mounted in seconds

The pre-mounted stay arm bearing is only inserted into the frame corner and fixed by tightening the clamping screws. The stay arm and the stay arm hinge are simply pushed together, quickly connected and secured by turning the stay arm bolt.

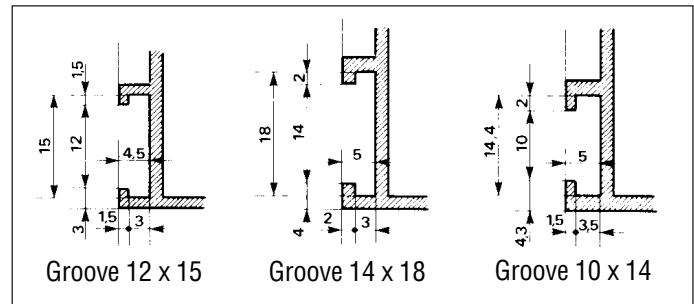

Corner bearing with hinge

The corner bearing with its axle is inserted into the pre-mounted frame casing. The clamping angle is pushed into the sash groove and then screwed onto the corner hinge.

The hinge can be adjusted: sideways by ± 1 mm and in height by ± 1.5 mm. The stepless lateral adjustment is made in side hung position of the sash.



Corner transmission

4 stainless steel spring leaves transmit the thrust to the horizontal rod without loss of stroke. Clamping screws secure the seat of the corner transmission in the profile. The sash pressure can be adjusted on the locking pin.



Adjustable locking pins

Eccentric locking pins enable optimised pressure and tightness of the sash.



Wrong operation safety device

It is assembled together with the handle fastening screws in a single operation which prevents triggering of the tilt position when the sash is in side hung position.

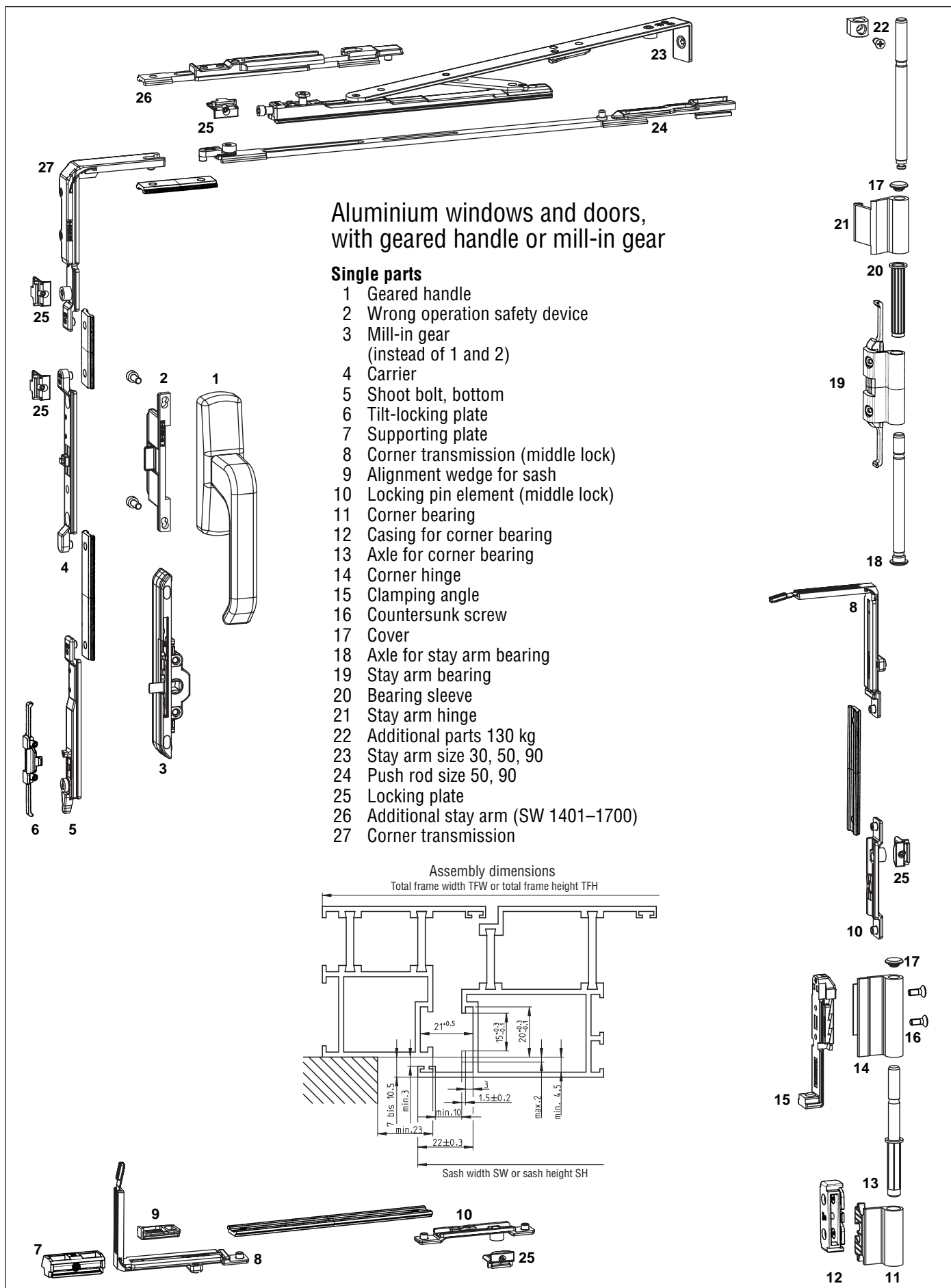

Aluminium windows and doors, with geared handle or mill-in gear

Single parts

- 1 Geared handle
- 2 Carrier
- 3 Mill-in gear without wrong operation safety device (instead of 1 and 2)
- 4 Locking pin element
- 5 Shoot bolt, bottom (middle lock)
- 6 Tilt-locking plate (middle lock)
- 7 Alignment wedge for frame
- 8 Alignment wedge for sash
- 9 Corner transmission
- 10 Corner bearing
- 11 Casing for corner bearing
- 12 Axle for corner bearing
- 13 Corner hinge
- 14 Clamping angle
- 15 Countersunk screw
- 16 Cover
- 17 Middle bearing
- 18 Axle for stay arm bearing
- 19 Stay arm bearing
- 20 Bearing sleeve
- 21 Stay arm hinge
- 22 Additional parts 130 kg
- 23 Side hung sash hinge
- 24 Locking plate
- 25 Corner transmission (middle lock)

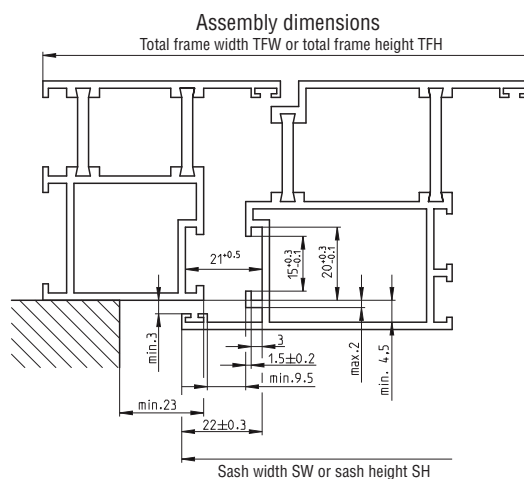

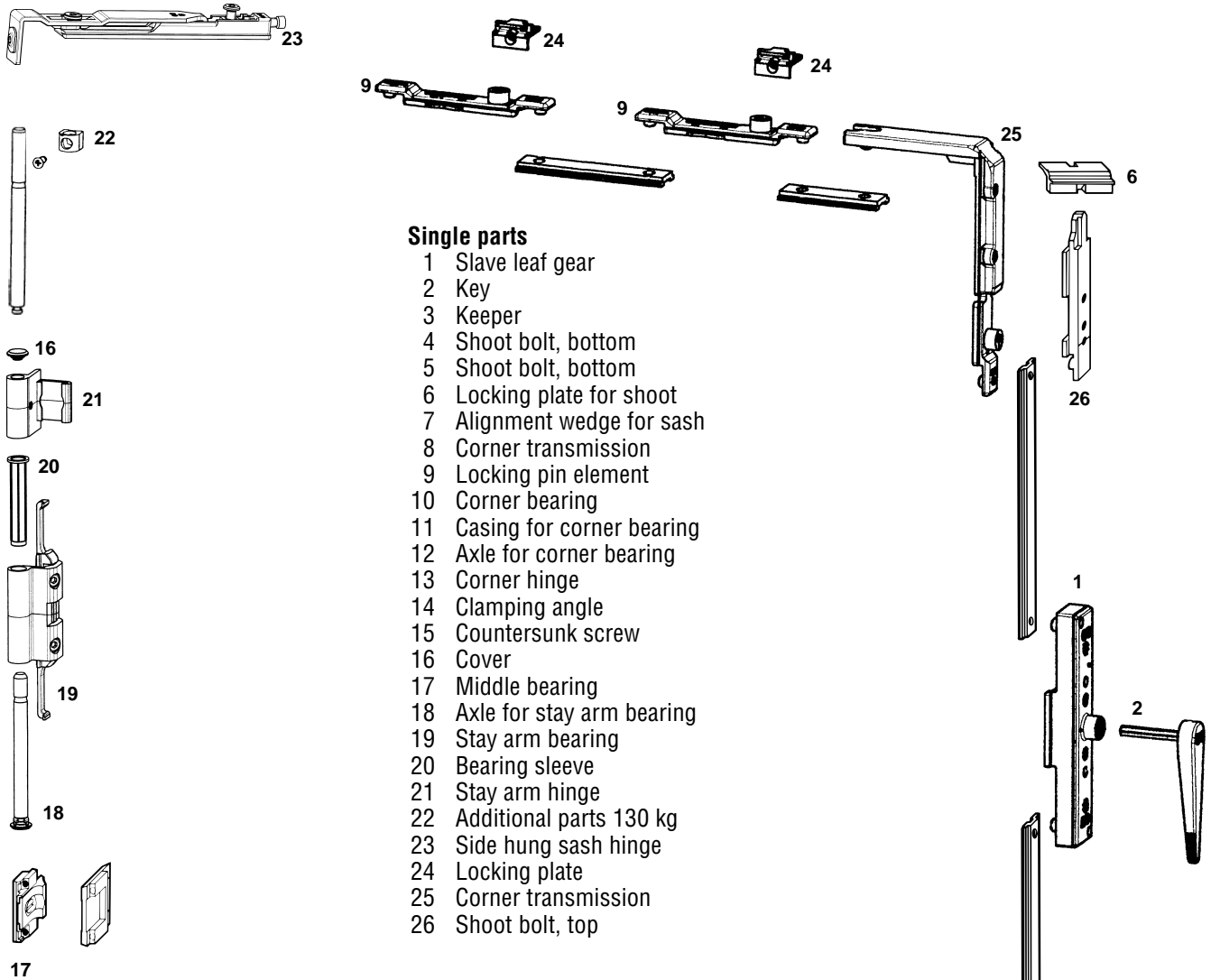

Assembly dimensions

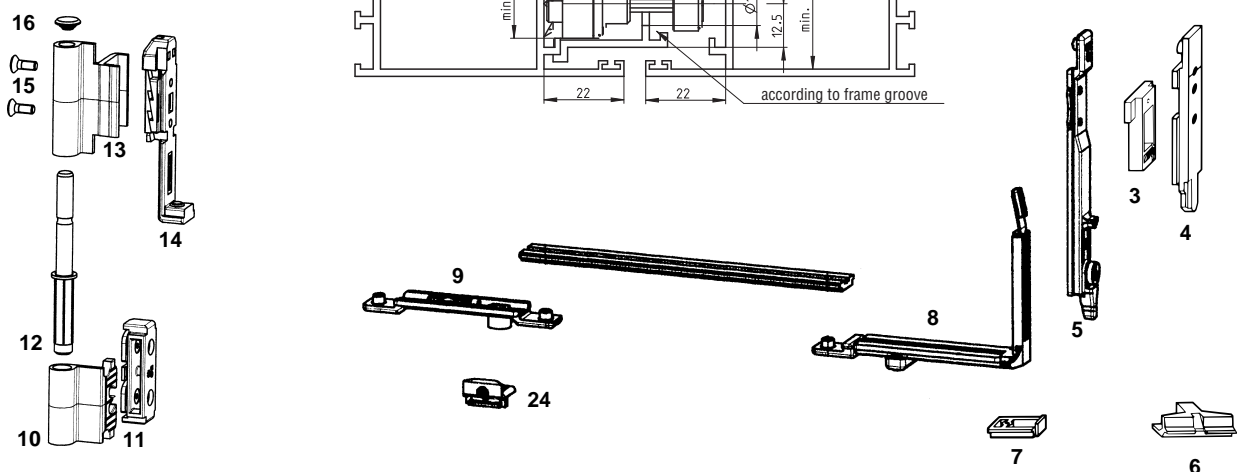
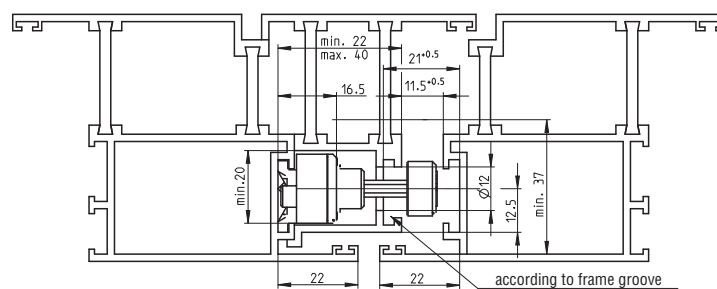

Specification

Tilt-turn windows and doors

Tilt-turn fittings JET AK 8 according to scheme A (B, C, D, E), for sashes to 80 kg (130 kg).

Clampable fittings for sashes with rebate clearance of 21 mm, Euro-groove 15 x 20 mm in the sash and groove 12 x 15, 14 x 18 or 10 x 14 mm in the frame.

Corner bearing adjustable + 2.5 mm or - 1.5 mm in height, ± 1 mm laterally, stay arm adjustable ± 3 mm, sash pressure adjustment ± 1 mm.

Identical shape of stay arm and corner bearings.

The fittings with one handle operation are concealed within the rebate. The locking pins of the gear parts, stay arms and corner transmissions are adjustable.

From a width of 1400 mm the sashes are equipped with an additional stay arm.

The corner transmissions are provided with rust-proof 4-leaf steel spring assemblies.

Slave leaf windows and doors

Slave leaf fittings JET AK 8 according to scheme G (H, I), for sashes to 80 kg (130 kg).

Clampable fittings for sashes with rebate clearance of 21 mm, Euro-groove 15 x 20 mm in the sash and groove 12 x 15, 14 x 18 or 10 x 14 mm in the frame.

Corner bearing adjustable + 2.5 mm or - 1.5 mm in height, ± 1 mm laterally, side hung sash hinge adjustable ± 3 mm, sash pressure adjustment ± 1 mm.

Identical shape of stay arm and corner bearings.

The fittings with inactive sash gear or shoot bolt operation are concealed within the rebate.

The locking pins of the gear parts and corner transmissions are adjustable.

The corner transmissions are provided with rust-proof 4-leaf steel spring assemblies.

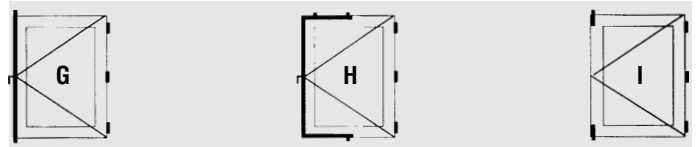
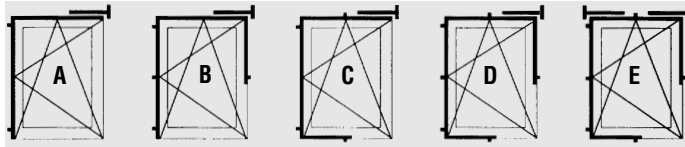

Side hung windows and doors

Side hung fittings JET AK 8 according to scheme A (A 1, B, C, D), for sashes to 80 kg (130 kg).

Clampable fittings for windows with rebate clearance of 21 mm, Euro-groove 15 x 20 mm in the sash and groove 12 x 15, 14 x 18 or 10 x 14 mm in the frame.

Corner bearing adjustable + 2.5 mm or - 1.5 mm in height, ± 1 mm laterally, side hung sash hinge adjustable ± 3 mm, sash pressure adjustment ± 1 mm.

Identical shape of stay arm and corner bearings.

The fittings with one handle operation are concealed within the rebate. The locking pins of the gear parts and corner transmissions are adjustable.

The corner transmissions are provided with rust-proof 4-leaf steel spring assemblies.

Materials, protection against corrosion

The fitting parts are made of high quality steel, zinc die-casting and aluminium alloys.

After zinc plating and standard bichromating surface treatment the zinc die-casting parts receive the additional silver coloured coating ferGUard* silver.

This particularly high quality sealed coating provides permanent first class protection against corrosion for all surfaces (corresponds to future EU environmental protection requirements). Aluminium parts are anodized or powder coated.

The steel parts consist of stainless alloys.

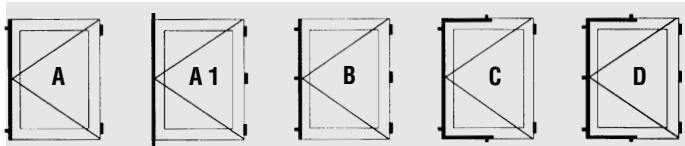

Gretsch-Unitas GmbH
Baubeschläge
D-71252 Ditzingen
Phone +49 7156 301-0
Fax +49 7156 301-293
Internet <http://www.g-u.de>
E-Mail Vertrieb-Ausland@g-u.de

Gretsch-Unitas Ltd
Unitas House, Quinn Close
Coventry CV3 4LH
Phone +44 24 76 21 79 00
Fax +44 24 76 21 79 09
Internet <http://www.g-u.co.uk>
E-Mail Help@g-u.co.uk